

MIMO

muraflex

MIMO: MINIMAL & MODERN

MIMO is a highly versatile and customizable demountable wall system thanks to its unique modular design, and therefore lends itself perfectly to your specific requirements. Engineered to address multiple configurations for different applications, MIMO can easily be interchanged from center glaze to offset glaze to double glaze, whether it is in 3/8" or 1/2" glass, all using the same core profile. MIMO is the go-to system for many esteemed companies who have made it the standard for their new office installations such as PricewaterhouseCoopers, AIG, Citi Bank, Chase Bank, to name a few.



GLASS

Available with 1/4", 3/8" and 1/2" glass, MIMO's system is engineered to go up to 12'-0" in height. Standard glass panel widths reach up to 4'-0" in 3/8" glass, and up to 5'-0" in 1/2" glass.

PROFILES

MIMO was designed with a slim and minimalist aesthetic in mind. Its slender and sophisticated profile measuring 1-9/16"H x 3"W welcomes carefully conceived gaskets in order to achieve the best STC ratings.

STC

MIMO is able to respond to a wide range of acoustic requirements, from STC 34 to STC 45, depending on wall configuration.

SUSTAINABILITY

Muraflex is a GREENGUARD and GREENGUARD GOLD certified company. MIMO frames are made from fully recyclable aluminum as well as Muraflex's proximity makes MIMO a more sustainable option for your project. All attributed credits and LEED points have been pre-calculated and all supporting documentation is available upon request.



MATERIAL FINISHES

Muraflex offers 15 carefully-selected, design-savvy standard extrusion finishes and colors, the most popular being clear anodized aluminum. Requiring no silicone, MIMO is a butt joint system which uses multiple slender and simple trim pieces to join panels together. As MIMO's profiles can be adjusted to receive any panel material with a thickness ranging anywhere between 1/4" to 5/8", the possibilities are almost endless.

GLASS PANELS

CLEAR TEMPERED
FROSTED
LAMINATED
LOW IRON
ULTRA CLEAR
STAR FIRE
WRITEABLE
ETC

SOLID PANELS

WOOD VENEER
FABRIC TACK
PLASTIC LAMINATE
ACRYLIC
DECOR METAL
VINYL COVERED DRYWALL
PAINTED DRYWALL
ETC

TRIM (BETWEEN GLASS PANELS)

ALUMINUM (ALL FINISHES)
POLYCARBONATE
GLASS TO GLASS (NO TRIM)

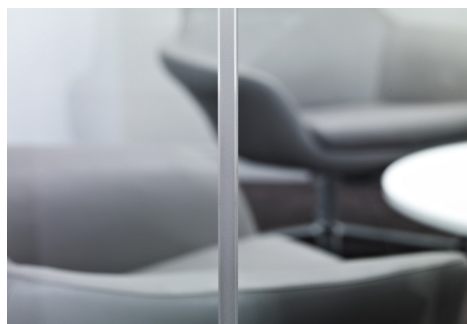

DOORS & HARDWARE

MIMO demountable walls can be configured with a wide variety of door options; sliding, hinged or pivoting, in glass or wood, framed or frameless, and with locking or non-locking hardware. MIMO's locking hardware is designed to accept standard American keyways, and can easily be adapted to receive card reader systems, such as magnetic locks, electric strikes, etc. The specification of custom hardware to meet the client's design intent is possible upon approval from Muraflex.

As a unique feature and in keeping with a clean design aesthetic, MIMO's sliding door hardware is concealed within its frame.

EXTRUSIONS

POWDER COAT GLACIER WHITE
GROUP 1

POWDER COAT LIGHT GRAY
GROUP 1

POWDER COAT TAUPE
GROUP 1

POWDER COAT CHARCOAL
GROUP 1

POWDER COAT BLACK
GROUP 1

POWDER COAT CUSTOM COLOR
GROUP 2

ANODIZED CLEAR
GROUP 1

ANODIZED CHAMPAGNE
GROUP 2

ANODIZED LIGHT BRONZE
GROUP 2

ANODIZED BLACK
GROUP 2

ANODIZED ARCHITECTURAL BRONZE
GROUP 4

FAUX BOIS LIGHT OAK
GROUP 3

FAUX BOIS DOUGLAS FIR
GROUP 3

FAUX BOIS WARM CHERRY
GROUP 3

FAUX BOIS CHESTNUT
GROUP 3

FAUX BOIS WALNUT
GROUP 3

MURAFLEX

Muraflex focuses solely on the demountable wall industry, aiming for the improvement of the work environment and is dedicated in delivering full turn-key solutions at all times. Although inspired from European style, all Muraflex products are designed and manufactured in North America — all design, engineering, product development and functionality is done in-house. With many installations in every major North American metropolitan area, Muraflex has an important presence on the market.

Muraflex understands that some projects call for additional coordination and, when required, offers on-site project management services with their team of available and highly-experienced project managers. The standard lead time for MIMO is from 6 to 8 weeks after reception of field measurements and approved shop drawings.



INSTALLATION & ADJUSTABILITY

Because time is always of the essence during the installation phase of every project, Muraflex developed a packaging and shipping system that makes the unloading and placing of extrusions easier as each elevation is packaged separately and identified with the room and elevation number it belongs to. Our glass is also identified in the same way with a tag identifying the room and elevation number. In addition, Muraflex performs any machining necessary in the factory prior to shipping, therefore eliminating this step from being done in the field, reducing the installation time for MIMO to approximately 1 h 15 minutes per linear foot. To further facilitate its installation, MIMO frames allow for total traveling of 1-1/4".

CONFIGURATIONS

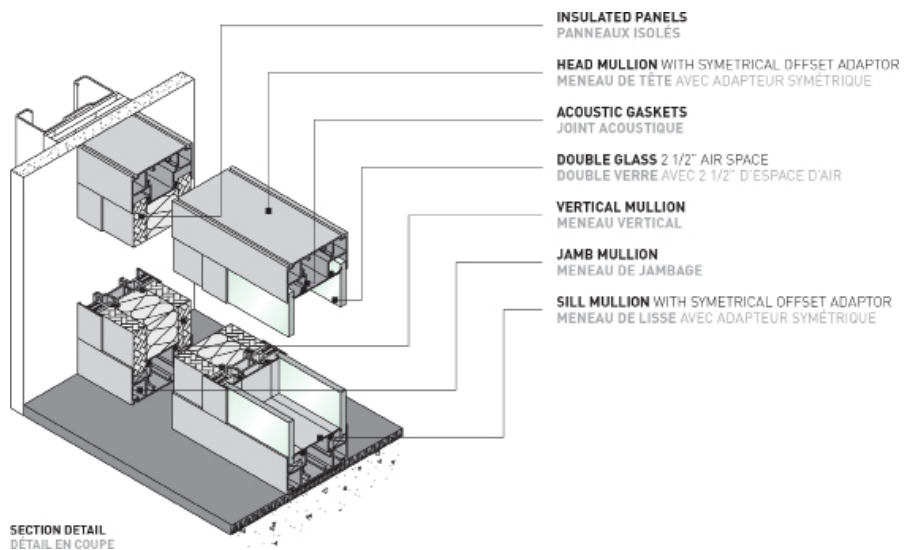
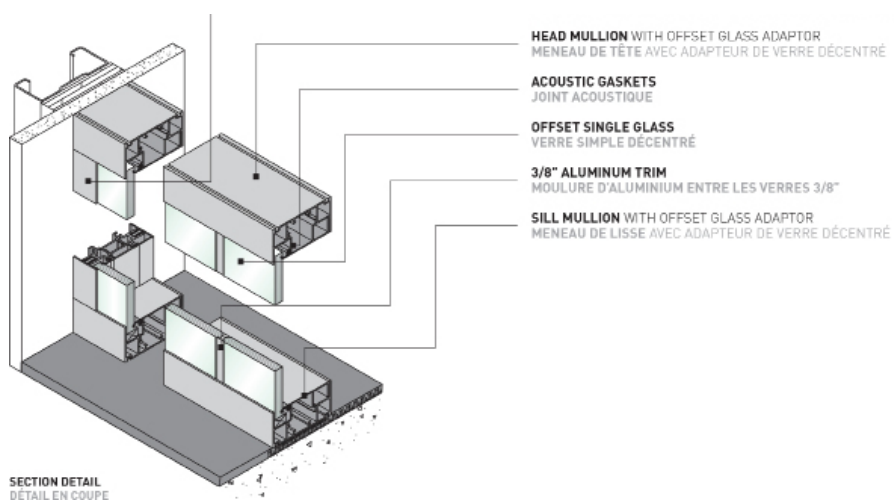
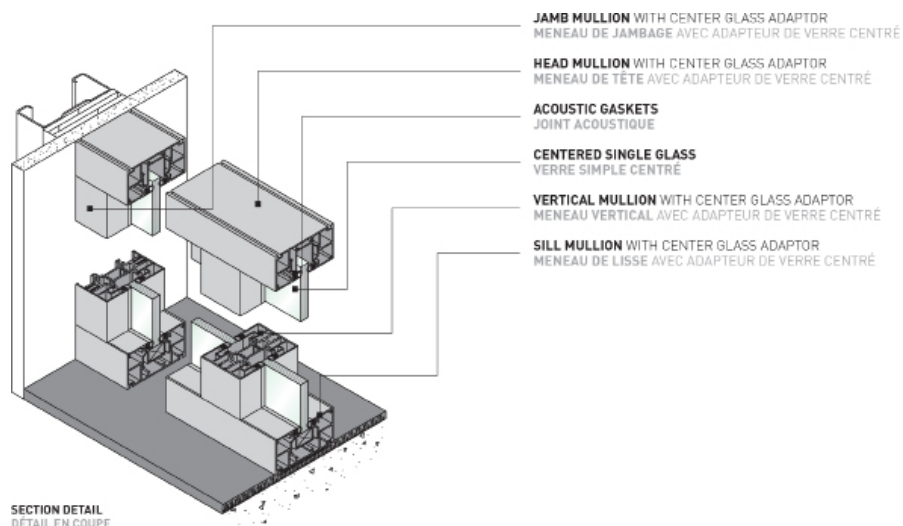

CONSTRUCTION DETAILS

CEILING ATTACHMENTS:

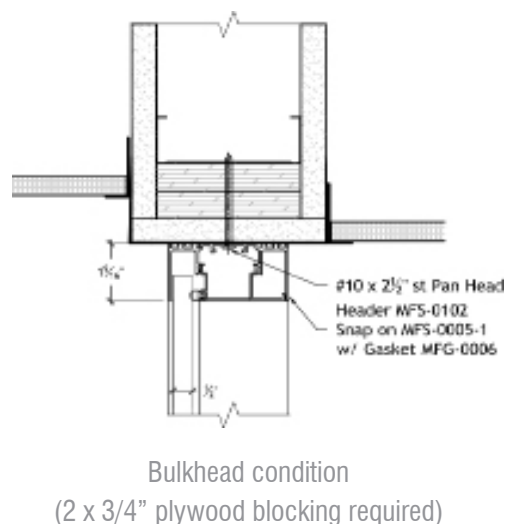
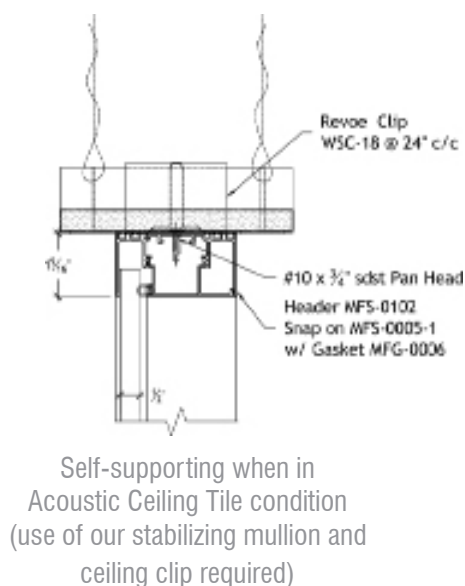

FLOOR ATTACHMENTS:

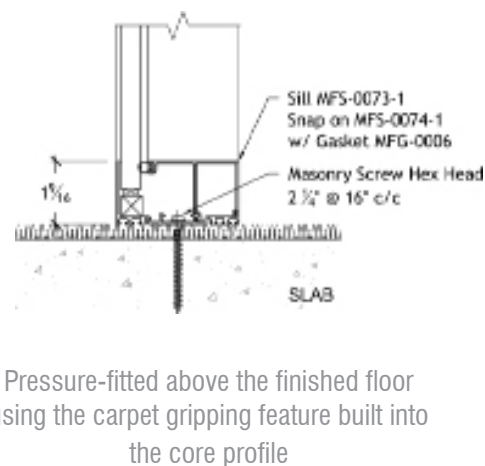
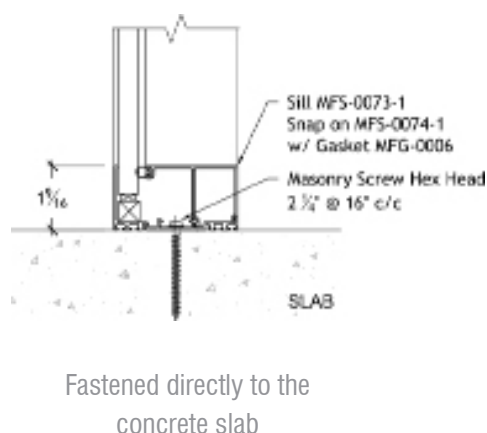

WALL JAMB ATTACHMENT:

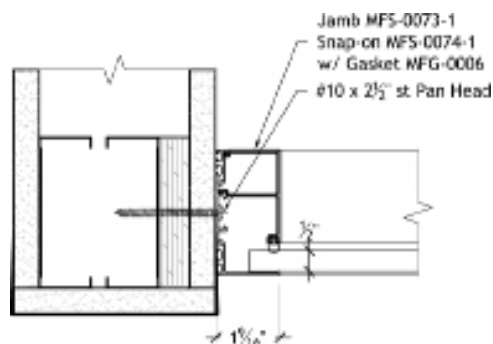

To ensure the system is stable,
1 x 3/4" plywood blocking is required in
support construction

Note: General Contractor to provide necessary blocking, bracing and support required to receive our products.